

# Options Online Setup Guide For Students



Go to the internet homepage and click **'Register To Choose Options Online'** or use the link on the Options Website



Use the **'Log in with Microsoft'** button, using the link as shown (do not use any other options) :

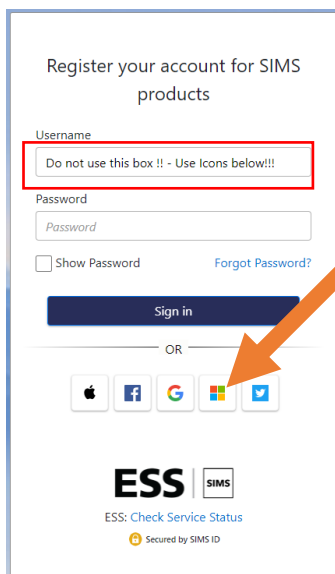

This should sign in automatically, If you are prompted for your username/password **after** clicking the **'Sign in with Microsoft'** button – use your school email address and password (the same login you use for Google Classroom)

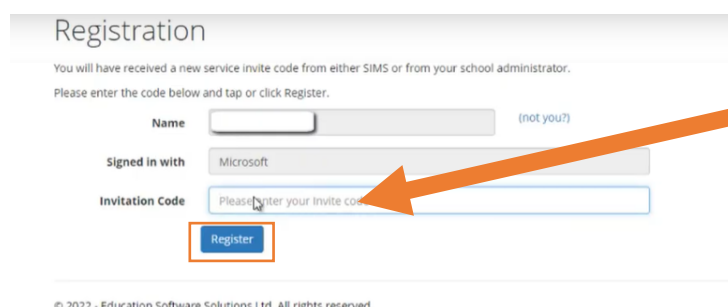

Enter your invitation code into the box as shown and click **Register**